

Phone* Introduction

USING THE PHONE IN THE VEHICLE

WARNING

Use of your phone handset while you are driving is dangerous as it diverts attention from the traffic situation. In some countries, use of a phone handset whilst driving is prohibited and in other countries a hands-free unit must be used. If you wish to use your phone handset, stop at an appropriate place where you are not endangering or inconveniencing other vehicles.

Using the telephone near the car:
Do not telephone inside a garage or near an open car bonnet. The air may contain fuel vapours and the telephone could produce sparks and start a fire.

Unusual ambient conditions:
Switch off the telephone in areas where high explosives are being used. High frequency remote controls could be interfered with and cause an explosion.

Switch off your telephone in areas with a high explosion risk. This includes filling stations, fuel storage areas or chemical factories, as well as places where the air contains fuel vapour, chemicals or metal dust. The telephone might possibly produce sparks and cause a fire or explosion.

Medical equipment:
The functioning of cardiac pacemakers or hearing aids may be impaired when the phone is in use. Check with a doctor or manufacturer whether any such devices you or your passengers are using are sufficiently protected against high-frequency energy.

Note: The integrated phone system is designed to function with a wide variety of docked and bluetooth portable phones. As these phones have a wide range of audio and echo performance characteristics, it may take a few seconds for the vehicle system to adapt and deliver optimal audio performance. In some cases, it may be necessary to reduce the in-vehicle volume slightly to fully optimise audio performance and echo elimination.

GSM NETWORKS

The GSM (Global System for Mobile communication) standard allows you to use your phone in many countries and has a uniform emergency call number (112) irrespective of the country in which you are driving.

It is possible that telephone reception may be poor or unavailable in remote regions. This will usually be due to the inadequate power of the transmitter and, therefore, to incomplete coverage. Depending on your location, you may also be using the transmitters of a network operator with which your service provider has an agreement for handling your calls.

Phone Docking Cradle

ATTACHING YOUR PHONE

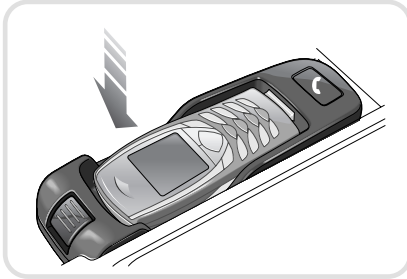
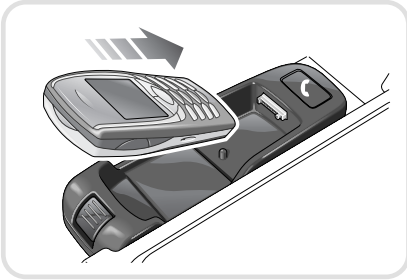

ICE 2310 ENG

1. Lift the top of the cubby box.
2. Insert the base of your phone into the docking cradle.
3. Push down on the upper part of your phone, until a click is heard from the cradle. **Phone Attached** appears in the head unit display screen.

Note: Your mobile phone will be charged while Docked in the cradle. Dependent upon phone make/model, charging can continue for up to 10 minutes after the ignition has been turned off.

REMOVING YOUR PHONE

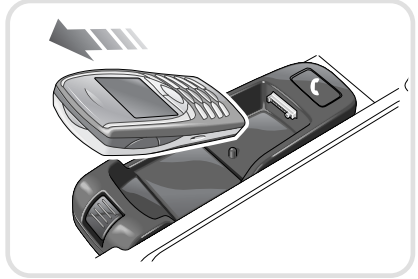
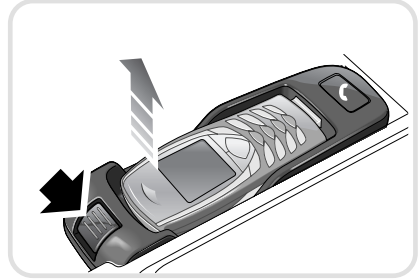

ICE 2311 ENG

1. Press down the release button at the front of the docking cradle and lift the upper part of your phone. **Phone Removed** appears in the head unit display screen.
2. Pull your phone forwards to remove from the cradle.
3. Lower the top of the cubby box.

Phone Controls

PHONE CONTROLS

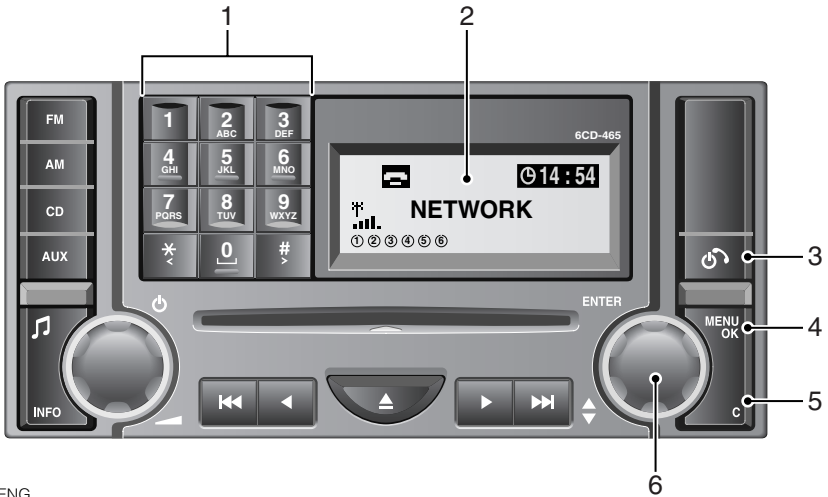

ICE2278 ENG

- | | | |
|------------------------|------------------|-------------------------|
| 1. Alphanumeric keypad | 2. Display | 3. Phone button |
| 4. MENU OK button | 5. Cancel button | 6. Rotary/Enter control |

REMOTE PHONE CONTROLS

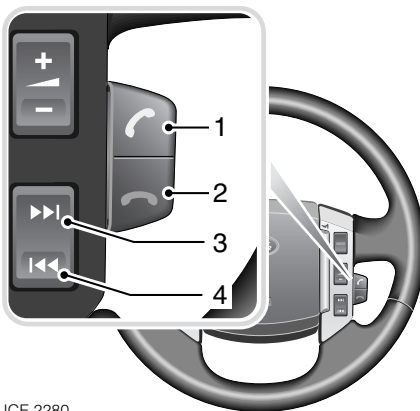

ICE 2280

1. Answer call/dial switch
Pull the switch briefly towards the steering wheel to answer an incoming call or dial a displayed number. Pull and hold the switch (for approximately 2 seconds), to redial the last number dialed.
2. End/reject call switch
Pull the switch towards the steering wheel to end the current active call or reject an incoming call.
3. Menu/Next button
Press to scroll down through a menu.
4. Menu/Prev button
Press to scroll up through a menu.

Phone Controls

Voice control switch



ICE1901 ENG

To activate voice control, pull and hold the voice control switch (arrowed) towards the steering wheel until an acoustic signal sounds.

Pull and release the switch before giving a voice command.

For further information, please refer to **TELEPHONE VOICE RECOGNITION, 119**.

PHONE DISPLAY

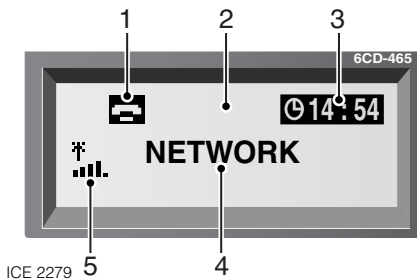

1. Call status icon
2. Call status
Caller ID
Number received/dialed
3. Clock
4. Network provider name
5. Signal strength indicator

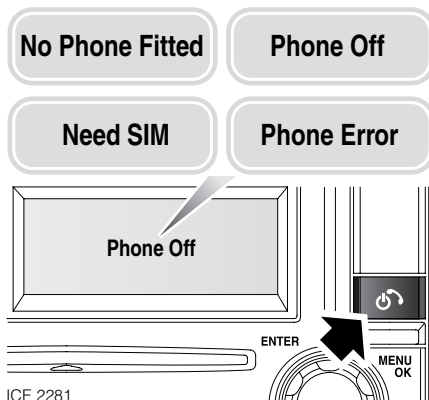

In addition, confirmation and error messages appear in the display (examples above). These messages and their meanings are covered in the relevant sections of this handbook.

Basic Functions

SELECTING PHONE MODE

Once your phone is docked in the cradle and switched on, you can select the phone system.

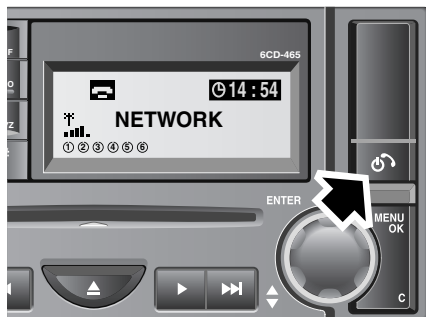

ICE 2282

Briefly press the **Phone** button (arrowed) or operate the **Answer call** switch on the steering wheel. Visual confirmation of phone operation is given via the display.

Note: Once Phone mode is selected, if there is no user action within 30 seconds, the system reverts to Audio mode and Phone mode will need to be reselected.

If a phone system is not fitted to your vehicle, **No Phone fitted** is displayed when Phone mode is selected.

If the phone has no SIM card fitted, **Need SIM** is displayed.

To exit Phone mode, briefly press the **Cancel** button or operate the **End call** switch on the steering wheel.

USING DISPLAY MENUS

Many of the functions available for the phone are accessed through menus on the display.

Press the **MENU OK** button briefly to access the menu relevant to the current phone mode (different menus are available in different modes).

- Press the button, when there is no active call, to access the Phone menu.
- Press the button during a call to access the In-Call menu.
- Press the button during a multiple connection to access the Multiple Connection menu.

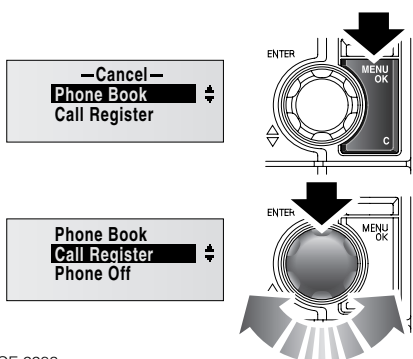

ICE 2283

Use the rotary control to highlight the chosen menu item, by turning the control clockwise to scroll down or anti-clockwise to scroll up through the chosen menu. Press the rotary control or press the **Phone** button to select the highlighted item. The menu **Prev** and **Next** buttons on the steering wheel can also be used to scroll through menus.

Note: In addition, there is also a Phone book (see **PHONE BOOK, 113**) and Call Register information (see **USING THE CALL REGISTER, 109**).

Basic Functions

TURNING THE PHONE ON/OFF

Phone Off

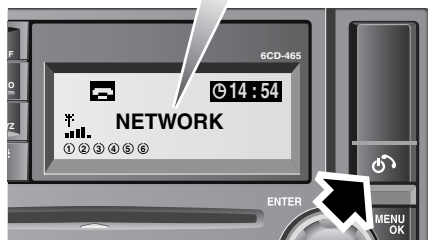

ICE 2286

To turn the phone on/off using the phone system controls, press and hold the **Phone** button (arrowed) for approximately 2 seconds. **Phone On** or **Phone Off** will be displayed for approximately 5 seconds before the display changes to the phone display if switching the phone on, or the Audio system display if switching the phone off.

ENTERING THE PHONE PIN

When turning on a phone which requires a PIN (Personal Identity Number) input, **Enter PIN:** will be displayed when Phone mode is selected.

Note: If Phone mode was entered by mistake, briefly press the **Cancel** button to return to Audio mode.

Enter the PIN, using the following process:

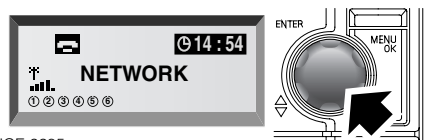
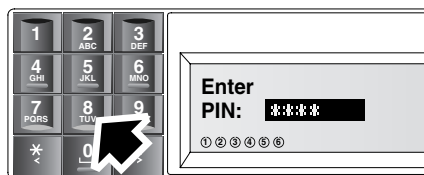
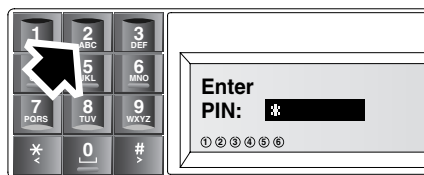

ICE 2285

1. Input your four digit PIN via the alphanumeric keypad. If an error is made, briefly press the **Cancel** button to clear the last digit or press and hold the button to clear all digits.
2. When you have entered your PIN, briefly press the rotary control to submit the PIN.
3. If the PIN is valid, a short pause will occur before Phone mode is entered (the display will change accordingly). Do not operate any of the audio system or phone controls until the phone has entered Phone mode.

Basic Functions

Invalid PIN entry

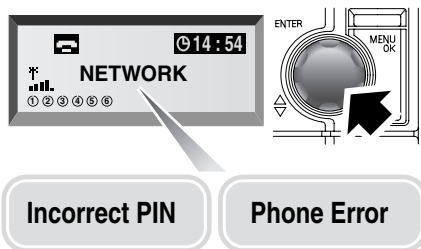

ICE 2307

If the PIN is invalid, **Incorrect PIN** will be displayed for approximately 5 seconds before the PIN entry display appears again.

Wait for the PIN entry display to appear, then enter the correct PIN.

Note: After 3 incorrect attempts at entering the PIN are made, **Phone Error** is displayed. It will be necessary to have the PIN reset. Consult the instruction manual provided with the phone for details.

SIGNAL STRENGTH

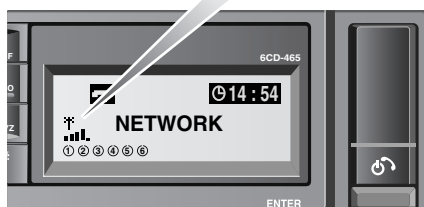
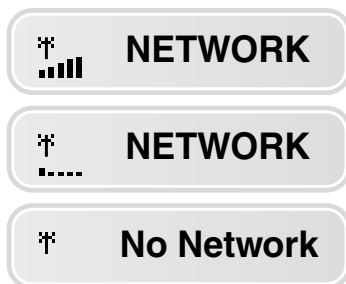

ICE 2284

The strength of the signal currently being received by the phone, is represented in the display by a series of bars. The more bars displayed, the stronger the signal available.

If you are in an area where no signal for your network is available, **No Network** is displayed and calls can be neither made nor received until signal strength improves.

Making Calls

DIALLING

Dialling a number manually

With the phone turned on, access Phone mode as described previously. Ensure that signal strength is sufficient.

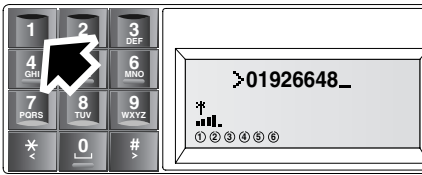

ICE 2287

Use the alphanumeric keypad to enter the phone number to be dialled. The digits of the number appear in the display.

When all the digits of the phone number have been entered, briefly press the **Phone** button (arrowed in middle illustration) or operate the **Answer call** switch on the steering wheel, to dial the number, **Dialling** appears in the display.

Note: Pressing the **Cancel** button briefly or operating the **End call** switch on the steering wheel when the phone is dialling, will cancel the call.

Note: If you wish to dial a number stored in the phone book, please refer to **PHONE BOOK, 113**. If you wish to dial a number stored in the Call Register (missed or received calls, or dialled numbers), please refer to **USING THE CALL REGISTER, 109**.

Correcting/clearing number entries



ICE 2288

If an incorrect digit is entered, press the **Cancel** button (arrowed) briefly to delete the last digit, then enter the correct digit.

Press and hold the **Cancel** button (for approximately 2 seconds) to delete all entered digits.

Last number redial

The last number dialled can be redialled using the **Answer call** switch on the steering wheel. If Phone mode is active, press and release the switch. If Phone mode is not active, press and hold the switch. The number will appear in the display and in the main message centre and will be dialled. To cancel dialling, operate the **End call** switch on the steering wheel.

Making Calls

USING THE CALL REGISTER

Using the redial list

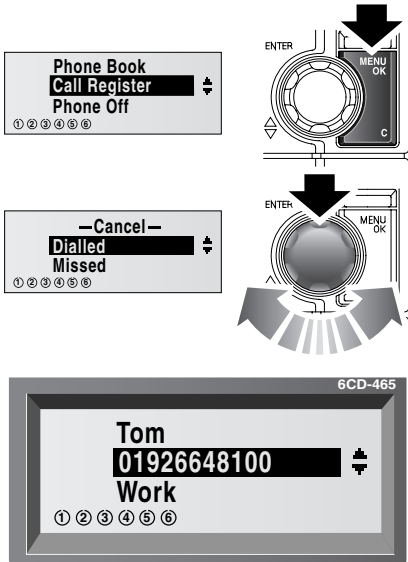

ICE 2308

1. Press the **MENU OK** button to access the Phone menu.
2. Use the rotary control to highlight and select **Call register**.
3. Highlight and select **Dialled** from the list of options using the rotary control.
4. Use the rotary control to scroll through the list of dialled numbers until the desired number is highlighted.
5. Press the rotary control or the **Phone** button, to select and dial the chosen number.

To exit the redial list without selecting an entry, scroll through the list until **Cancel** is highlighted, then press the rotary control to select. The system returns to the previous menu.

Using the received call list

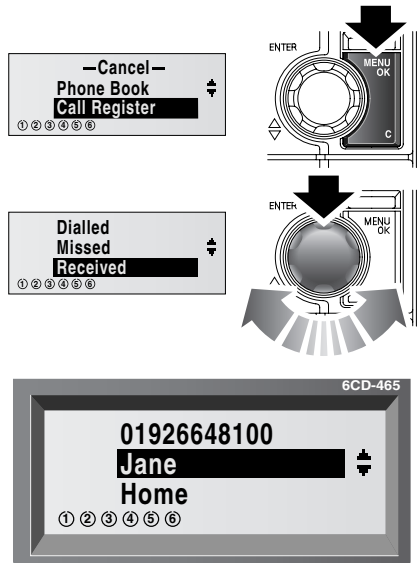

ICE 2290

1. Press the **MENU OK** button to access the Phone menu.
2. Use the rotary control to highlight and select **Call register**.
3. Highlight and select **Received** from the list of options using the rotary control.
4. Use the rotary control to scroll through the list of received numbers until the desired number is highlighted.
5. Press the rotary control, the **Phone** button or operate the **Answer call** switch on the steering wheel, to select and dial the chosen number.

To exit the received call list without selecting an entry, scroll through the list until **Cancel** is highlighted, then press the rotary control to select. The system returns to the previous menu.

Making Calls

Using the missed call list

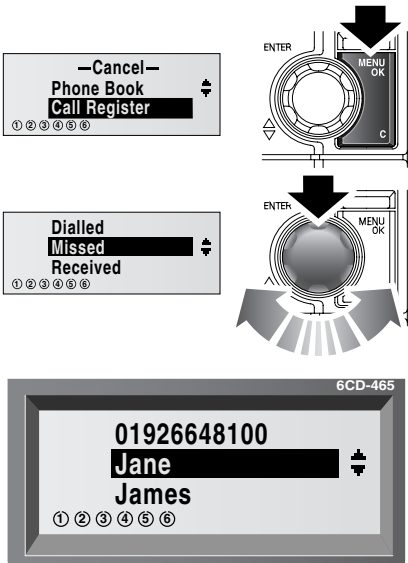

ICE 2291

1. Press the **MENU OK** button to access the Phone menu.
2. Use the rotary control to highlight and select **Call register**.
3. Highlight and select **Missed** from the list of options using the rotary control.
4. Use the rotary control to scroll through the list of missed call numbers until the desired number is highlighted.
5. Press the rotary control, the **Phone** button or operate the **Answer call** switch on the steering wheel, to select and dial the chosen number.

To exit the missed call list without selecting an entry, scroll through the list until **Cancel** is highlighted, then press the rotary control to select. The system returns to the previous menu.

Receiving Calls

ANSWERING/REJECTING CALLS

Answering an incoming call

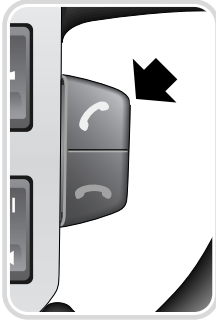

ICE 2292

When an incoming call is received, the number or caller ID (if entered into the Phone book) will appear in the phone system display and also in the main message centre in the instrument panel.

The call can be answered in three ways:

- Operate the **Answer call** switch on the steering wheel (arrowed in inset).
- Press and release the **Phone** button (arrowed in main illustration).
- Press and release the **MENU OK** button.

Ending a call



ICE 2293

To end a phone call, whether incoming or outgoing, operate the **End call** switch on the steering wheel (arrowed in inset) or press and release the **Cancel** button (arrowed in main illustration).

Note: If the Scratchpad function is active, use the **End call** switch on the steering wheel to end a call.

Rejecting an incoming call

To reject an incoming call without answering, operate the **End call** switch on the steering wheel or press and release the **Cancel** button.

Receiving Calls

SCRATCHPAD

This function enables you to note down a number while in an active call.

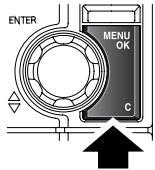
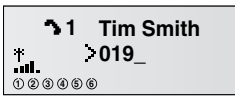
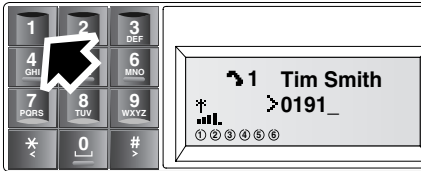

ICE 2295

Using brief presses, use the alphanumeric keypad to enter the number onto the display (the number will appear on the second line of the display). This will not interrupt the current active call.

To enter a + character (for an international number, for example), press and hold the **0** key for approximately 1 second.

If an incorrect digit is entered, briefly press the **Cancel** button to delete the last digit, or press and hold the **Cancel** button to delete the entire number.

Note: Pressing the **Cancel** button when the Scratchpad function is active, will not end the current active call.

To end the current active call without first deleting the scratchpad entry, either operate the **End call** switch on the steering wheel, or briefly press the **OK MENU** button to access the In-Call menu, then use the rotary control to highlight **End Call** and press the control to select.

If the active call is ended with the Scratchpad entry still displayed, the Scratchpad entry will move up to the top line of the display.

Making a call using the Scratchpad entry



ICE 2294

To dial the number entered using the Scratchpad, briefly press the **Phone** button, or operate the **Answer call** switch on the steering wheel.

This function can be used during an active call. 'Dialling' will appear in the display and the current active call will be put on hold (this is also confirmed in the display).

The active call, whether it is the original call or the call made using the Scratchpad, can be ended either by operating the **End call** switch on the steering wheel, or by briefly pressing the **Cancel** button. The number (or caller ID) of the remaining active call will occupy the top line of the display and this call will no longer be on hold.

For information on making multiple calls, refer to **MULTIPLE CONNECTIONS, 115**.

Phone Book

PHONE BOOK

When your phone is docked in the cradle, your phone/address book details are accessible via the integrated Phone system controls.

Selecting the Phone book

Access the Phone book by turning the rotary control or by pressing either the menu **Next** or **Prev** button on the steering wheel.

To exit the Phone book without selecting an entry, scroll through the list until **Cancel** is highlighted, then press the rotary control to select. The system returns to the previous menu.

Alternatively, the Phone book can be accessed via the Phone menu.

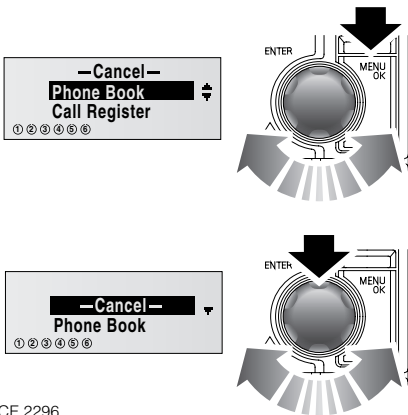

ICE 2296

1. Press the **MENU OK** button to access the Phone menu.
2. Use the rotary control to highlight and select **Phone Book**.

Note: To exit the Phone menu without selecting the Phone book, highlight and select **Cancel**.

Phone book scroll

There are two methods of selecting a contact name from the Phone book. This method should be used to browse through the contacts listed in the Phone book.

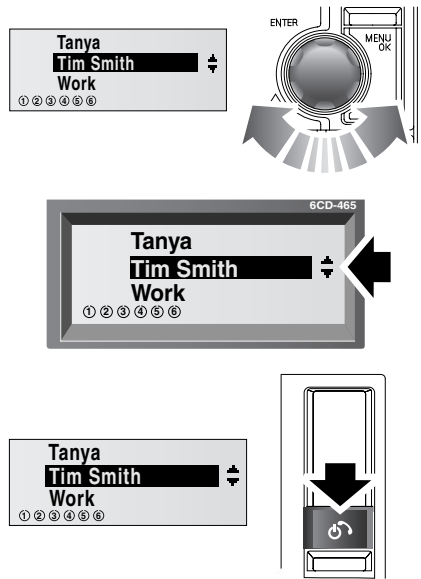

ICE 2297

To navigate through your contact list, turn the rotary control clockwise or press the menu **Next** button on the steering wheel (see **REMOTE PHONE CONTROLS, 103**), to scroll down through the Phone book. To scroll up through the list, turn the rotary control anti-clockwise or press the menu **Prev** button on the steering wheel.

If the menu **Next** and **Prev** buttons are used to scroll through the Phone book, the entry currently highlighted in the display will also appear in the main message centre in the instrument pack. The message centre will display the caller ID, alternating at 3 second intervals with the phone number.

Phone Book

Note: If scrolling is carried out using the rotary control, the caller ID/phone number is **NOT** displayed on the message centre.

Once the chosen Phone book entry is highlighted, press the rotary control, the **Phone** button or operate the **Answer call** switch on the steering wheel, to select the entry and dial the number.

If the entry was selected by mistake, either operate the **End call** switch on the steering wheel, or press and release the **Cancel** button to cancel dialling.

Phone book alphabetical search

This method should be used when you wish to narrow the search to the initial letter of the Phone book entry.

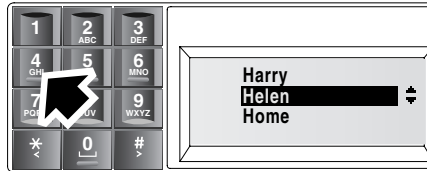

ICE 2298

With the Phone book displayed, press the appropriate alphanumeric key the corresponding number of times according to the initial letter of the entry.

For example; if the initial letter of the required Phone book entry is an **H**, press the **4** key of the alphanumeric keypad twice. The display will now show the entries starting with the letter **H**. Select the highlighted entry by briefly pressing the rotary control or the **Phone** button.

To exit the Phone book without selecting an entry, scroll through the list until **Cancel** is highlighted, then press and release the rotary control to select.

Multiple Connections

MULTIPLE CONNECTIONS

Note: This feature may not be supported on Prepay/Pay as you go mobile phones. (Network dependent).

Incoming call during another call

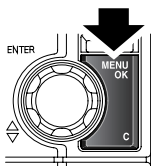

ICE 2299

If you are already in an active call when you receive another call, the caller number or ID appears in the display.

The current active call is automatically put on hold (confirmed on the display). Operate the **Answer call** switch on the steering wheel or press and release the **Phone** button to accept the incoming call.

The phone icon of the current active caller is highlighted in the display.

To reject the incoming call, operate the **End call** switch on the steering wheel, or press and release the **Cancel** button.

Multiple connection menu

To access the Multiple Connection menu, press the **MENU OK** button during a multiple connection.

To navigate through the menu, turn the rotary control clockwise to scroll down or anti-clockwise to scroll up through the list, until the desired entry is highlighted. Press the rotary control to select the entry.

To exit the Multiple Connection menu, highlight and select **Cancel**.

Multiple Connections

Swap active call

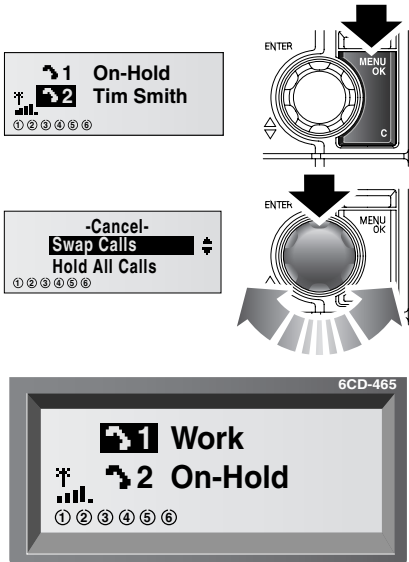

ICE 2300

During a multiple connection, it is possible to swap between callers.

Access the Multiple Connection menu as described previously. Scroll through the menu until **Swap Calls** is highlighted and then press the rotary control to select.

The current call will be put on hold and the call previously on hold will become active. This is confirmed in the display.

Resuming a call

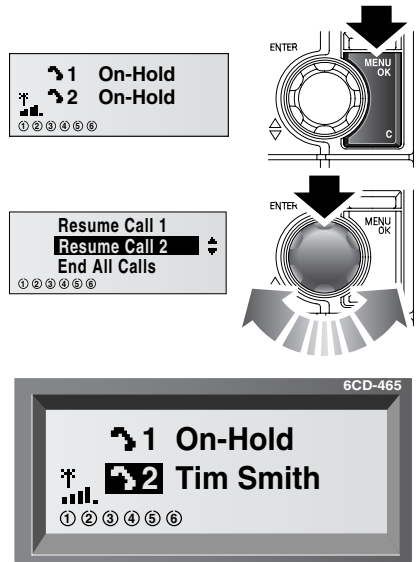

ICE 2303

If all current calls are on hold, resume the call with one of the callers, by highlighting and selecting the relevant **Resume Call** entry (either **Resume Call 1** or **Resume Call 2**) from the Multiple Connection menu (see **Multiple connection menu, 115**).

Multiple Connections

Ending one call

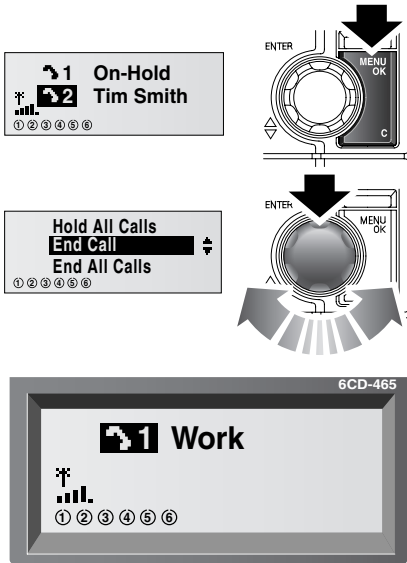

ICE 2304

To end the current active call, access the Multiple Connection menu as described previously (see **Multiple connection menu, 115**). Scroll through the menu until **End Call** is highlighted and then press the rotary control to select. The call previously on hold, now becomes the active call.

Alternatively, if there are no menus open, the current active call can be ended by pressing the **Cancel** button or by operating the **End call** switch on the steering wheel.

Ending all calls

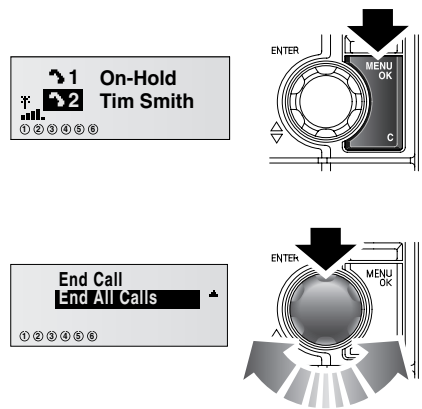

ICE 2305

To end all current calls, access the Multiple Connection menu as described previously (see **Multiple connection menu, 115**). Scroll through the menu until **End All Calls** is highlighted and then press the rotary control to select.

Bluetooth Operation

BLUETOOTH OPERATION

BLUETOOTH ACCESS CODE

The four digit access code required for Bluetooth Pairing operation is 2121.

PAIRING YOUR PHONE TO THE VEHICLE

If your mobile phone supports this wireless feature, it will need to be Paired to the vehicle. The Pairing process will also be described in your mobile phone instructions.

1. With the vehicle ignition on, select the Bluetooth feature on your mobile phone.
2. Start the Search function on your mobile phone.

Note: This search process may vary from one handset/manufacturer to another (consult your mobile phone instructions for further details).

Note: Typically, when searching for other wireless devices the search range is 10 metres or less.

3. The text **LAND ROVER** will appear on your mobile phone device list. This should be selected.

Note: **LAND ROVER** can be personalised by the user (e.g. the vehicle registration number).

4. Your mobile phone display will now prompt you for the Bluetooth access code. Press the numeric keys 2121 on your phone.
5. When the code is accepted, the system will allow you to use the Bluetooth mode.

Note: A maximum of 8 mobile phones can be Paired to the vehicle.

Note: If more than one Paired Bluetooth phone is in range, then the system will automatically select the last phone used in Bluetooth mode (if present).

Note: A phone docked in the cradle will always take priority over wireless operation. Alternatively, priority can be given to other phones by de-selecting Bluetooth mode on your mobile phone.

Bluetooth does not enable the user to access the Phone book stored on the Phone handset or SIM card. It only enables access to the phone numbers stored against name tags in the Voice Recognition system..

Note: If the phone book is selected when the phone is connected via Bluetooth, **Memory Empty** will be displayed for approximately 30 seconds.

Telephone Voice Recognition

TELEPHONE VOICE RECOGNITION

Voice control enables you to activate important functions of your telephone system, without the need to operate the controls manually. This enables you to concentrate fully on driving the vehicle, you do not need to divert your eyes from the road ahead in order to check read-outs, and the voice control system feeds back information to you.

A number of voice commands are available and, with a little experience, you will find them easy and convenient to use. Whenever you issue one of the defined commands with the system active, the voice control system converts your command into a control signal for the telephone system. Your inputs take the form of dialogues or commands. You are guided through these dialogues by announcements or questions.

Please familiarise yourself with the functions of your telephone system, before using voice control.

WARNING

Do not use the voice control for placing emergency calls. Your voice and tone could be affected by stressful situations as a result of which, the process of establishing the telephone connection could be unnecessarily delayed.

Making yourself clearly understood

The voice control system includes a special hands-free microphone mounted in the roof lining of your vehicle, at the front. This microphone filters out ambient noise. There are nevertheless a few points to observe in making sure you are properly understood:

- Speak continuously and at normal volume, avoiding unnatural emphasis and pauses between words.
- Do not speak while the voice control system itself is giving an output. The voice system displays **Listening** and gives a beep when it is waiting for a speech input.
- It is possible that noise interference from outside the vehicle could affect commands so to avoid this keep doors, windows and the sunroof closed.
- If a command is not understood or your speech was not heard, the voice system responds with >Sorry<, >Command not recognised< or >No speech detected<. Please try again if this happens.
- Avoid causing background noise in the vehicle while you are speaking and ask your passengers not to talk while you are issuing voice commands.
- The hands-free microphone is positioned to pick up the driver's voice. Other occupants of the vehicle could be understood with less accuracy and are, therefore, advised to use the handset when making a telephone call.

Note: *The voice recognition directory is separate from your phone handset SIM card address book/phone book.*

Telephone Voice Recognition

Defined voice commands

The voice control system understands predefined commands which need to be given word for word.

You can prompt the system to speak a selection of these commands by activating the system and giving the command **Phone help** or **Telephone help**.

Note: For each command below, the term **Phone** or **Telephone** are equally acceptable.

These commands are as follows:

Telephone commands

- **Phone dial number/Dial phone number**
- **Phone redial/Redial**
- **Phone dial name/Dial name**
- **Phone store name**
- **Phone play directory/Read phone book**
- **Phone delete directory/Clear phone book**
- **Phone help**

Telephone sub-commands

These commands are used in response to a prompt or question within a dialogue.

- **Correction**
- **Delete**
- **Cancel**
- **Store**
- **Dial**
- **Yes**
- **No**
- **Replay**
- **Numbers 0-9**
- **Double**
- **Treble/Triple**

Activating the system



ICE1901 ENG

To switch on voice control, press the voice control key (arrowed) in the multi-functional steering wheel:

- Hold the key pressed in (until the acoustic signal is heard) to activate voice control (your Audio will mute at this point, if switched on). A brief acoustic signal and **Listening** appearing in the audio display indicate that the system is now waiting for a spoken input.

Once the system is listening, give the desired voice command.

Before giving a new voice command - except during a dialogue - always press the steering wheel voice control key.

Telephone Voice Recognition

Interrupting voice control

A command can be interrupted by speaking the word **Cancel** or by pressing the steering wheel voice control key until the system responds by displaying **COMMAND CANCEL** in the Main message centre.

It is only possible to interrupt dialogues where you say a name in the voice recognition phone book, by pressing the steering wheel key.

If you receive a telephone call (or Navigation route guidance instruction/T.A. announcement) while conducting a dialogue by voice control, the telephone mode automatically cuts in.

GENERAL COMMANDS

Note: *The voice control commands you should give are shown in bold and the responses by the voice recognition system are shown inside chevrons >...<.*

Activating the user help function

The command **Phone help** calls up a list of telephone commands in spoken form.

Command not recognised

If a command is not recognised by the speech recognition system, it responds with **>Sorry<**.

Please say your command again.

Activating the user help function

You say	Voice output	Display output
Phone help	<i>(Reads out the telephone commands)</i>	<i>(Followed by telephone commands)</i>

Telephone Voice Recognition

DIALLING A PHONE NUMBER

Starting a dialogue

Hold the voice control key in the multi-functional steering wheel pressed in until the acoustic signal is heard. Any audio sources in the vehicle are muted.

The command **Dial telephone number**, or **Phone dial number**, start the dialogue for entering a telephone number. You are guided through this process by a predefined dialogue.

Saying numbers

The system understands single digits from zero to nine. You can choose to say either **Zero** or **Oh**.

Numbers such as ten, eleven, twelve etc. are not recognised.

To speed up input it is a good idea to group together between three and five digits into a continuous string. However, you can also say each digit individually, or all digits continuously.

Note: Telephone numbers of up to 20 digits are acknowledged. If a longer number is given, the following error message will be issued:

>Number too long<

Establishing a connection

The command **Dial** terminates input of the digits and a connection is established with the telephone number displayed.

Note: To make a foreign phone call say **Plus** followed by the country code.

Dialling a phone number

You say	Voice output	Display output
Phone dial number	>Phone dial number, Number please<	Dial Number Number Please
Zero, one, six, one	>Zero, one, six, one, continue?<	0161
Four, nine, six	>Four, nine, six, continue?<	0161496
Zero, nine, nine, eight	>Zero, nine, nine, eight, continue?<	01614960998
Dial	>Dialling<	Dialling

Telephone Voice Recognition

CORRECTING/DELETING AND CANCELLING INPUTS

When you are entering digits into the system, it will repeat back the numbers given, then asks you to continue. You may continue entering digits to complete your number or if you have made a mistake or if the voice control has misunderstood, you may say:

Correction, **Delete** or **Cancel**.

Correcting inputs

Correction to delete the last block of digits.

After the command **Correction**, the system repeats the digits that were entered correctly up to that point.

Deleting inputs

Delete, deletes all digits entered. It is then necessary to enter the digits again from the very beginning.

Cancelling voice session

Cancel terminates voice session.

Correcting/Deleting inputs

You say	Voice output	Display output
Phone dial number	>Phone dial number, Number please<	Dial Number Number Please
Zero, one, six, one	>Zero, one, six, one, continue?<	0161
Four, nine, six	>Four, nine, six, continue?<	0161496
Correction	>Zero, one, six, one, continue?<	0161
Four, nine, five	>Four, nine, five, continue?<	0161495
Delete	>Number please<	Number Please

Redialling

The command **Phone redial** or **Redial** dials the telephone number last used.

Redialling the last number used

You say	Voice output	Display output
Phone redial	>Phone redial, Confirm Yes or No<	Phone Redial Say Yes Or No
Yes	>Dialling<	Dialling

Telephone Voice Recognition

STORING A TELEPHONE NAME/NUMBER

Telephone numbers which you dial frequently can be stored in the Voice Recognition phone book in conjunction with the contact name.

Storing via voice command

The command **Phone store name** calls up the dialogue for storing a name. The name is entered first, then the number. The same rules for saying numbers apply as for the **Phone dial number** command.

If possible, keep names acoustically distinct from one another, for example, **Andrew Royd** and **David Royle** instead of **Mr Royd** and **Mr Royle**. This will improve recognition when you make a call.

Depending on the spoken length of the names and numbers you have entered, it is possible to store approximately 50 entries.

Storing via voice command

You say	Voice output	Display output
Phone store name	>Phone store name< >Name please<	Phone Store Name Name Please
Andrew Royd	>Number please<	Number Please
Zero, one, six, one	>Zero, one, six, one, continue?<	0161
Four, nine, six	>Four, nine, six, continue?<	0161496
Zero, nine, nine, eight	>Zero, nine, nine, eight, continue?<	01614960998
Store	>Stored<	Stored

Telephone Voice Recognition

USING THE VOICE RECOGNITION PHONE BOOK

Dialling a telephone number in phone book

The command **Phone dial name** activates the phone number in the directory corresponding to the name tag.

When prompted by the voice control system, speak the name under which you have stored the telephone number you want.

The voice control system will understand best the person who made the entries.

Dialling a telephone number in phone book

You say	Voice output	Display output
Phone dial name	>Dial name, Name please<	Dial Name Name Please
Andrew Royd	>Andrew Royd, Confirm Yes or No<	Say Yes or No
Yes	>Dialling<	Dialling

Telephone Voice Recognition

DIALLING/EDITING AND DELETING FROM THE PHONE BOOK

The command **Phone play directory** or **Read phone book** enables you to have all entries in your voice recognition phone book read out in order.

You may say one of the following after each name has been read out. Give the command **Dial, Replay, Delete, Edit, Cancel** or remain silent to advance to the next name.

Dialling from the phone book

You say	Voice output	Display output
Phone play directory You can say Dial, Replay, Delete, Edit or Cancel after each name. <i>(Reads out the entries)</i>	>Phone play directory<	Phone Directory <i>(Display numbers)</i>
Dial	>Phone dial name, Confirm Yes or No<	Dial Name Say Yes or No
Yes	>Dialling<	Dialling

Dialling

This function enables you to dial a telephone number stored in the phone book. This is useful if you have forgotten a contact's voice/name tag or if the tag is not recognised.

Replaying

This function repeats the name again from the phone book.

Deleting

This function enables deletion of a telephone number and name stored in the phone book.

Editing

This function enables voice editing of a telephone number of an existing name stored in the phone book.

Cancelling

Terminates the voice session.

Telephone Voice Recognition

DELETING/CLEARING THE ENTIRE PHONE BOOK

The command **Phone delete directory** or **Clear phone bookd** deletes all entries in the Voice Recognition phone book.

The names and telephone numbers entered in your Voice Recognition phone book are independent of the telephone or SIM card memory of your phone. In other words, it is not possible to recall or delete the numbers stored in the telephone itself or on the SIM card by voice input, nor is it possible to store numbers there by voice input.

Deleting/Clearing the entire phone book

You say	Voice output	Display output
Phone delete directory	>Phone delete directory, Confirm Yes or No<	Delete Directory Say Yes or No
Yes	>Are you sure you want to delete the whole directory?<	Say Yes or No
Yes	>Directory deleted<	Deleted